

# SPECIFICATION

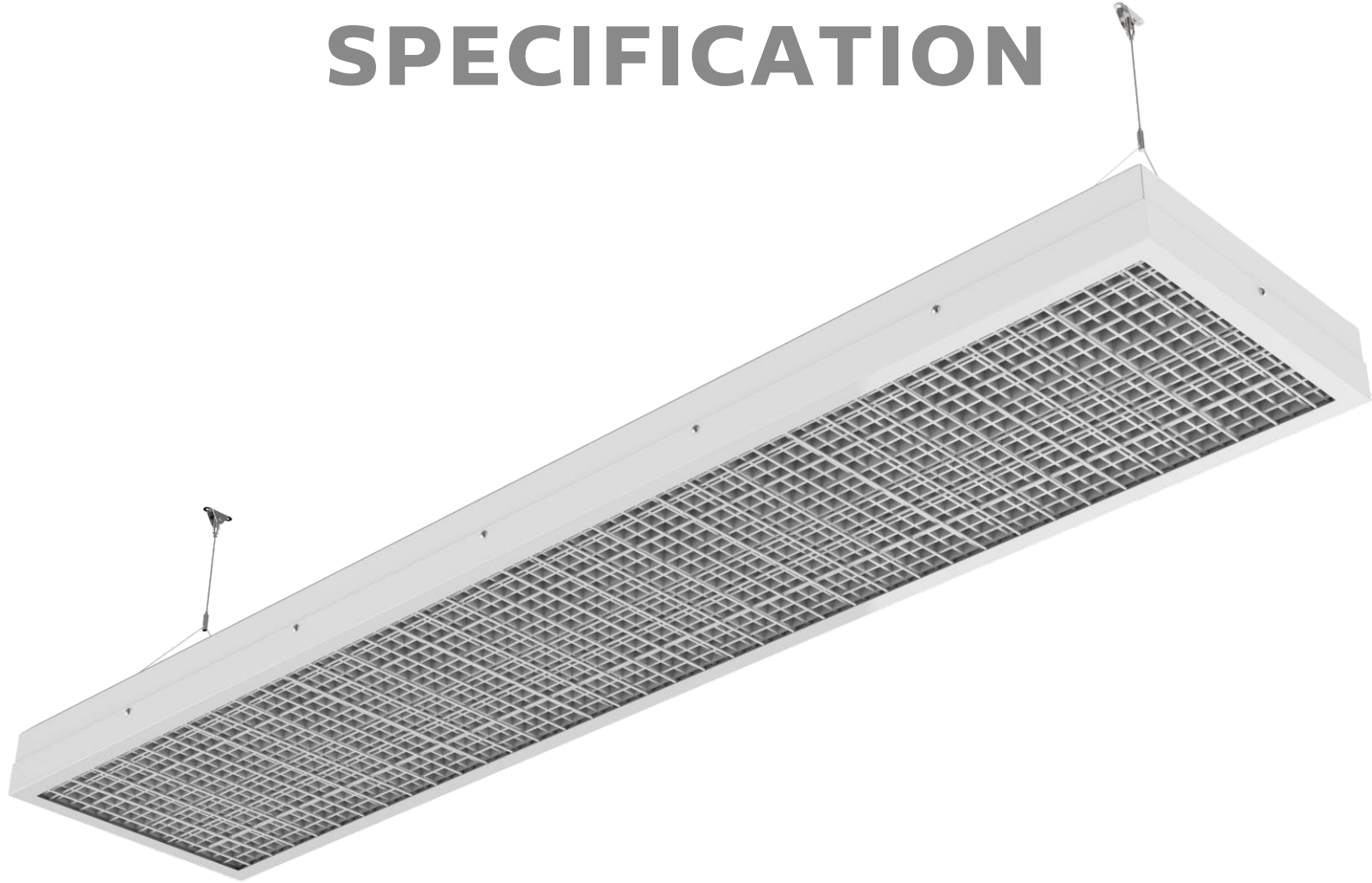

## ISP4 INDOOR LED SPORT LIGHT

(Low Glare for Your Sport Hall)

## Features



**DUAL RAYS**  
Intelligent. Healthy. Efficient.

### ISP4 Indoor LED Sport Light

(Low Glare for Your Sport Hall)

- > High Brightness SAN'AN SMD2835(0.5W) LEDs light source,CRI>80Ra,Meanwell XLG/ELG Driver, with 120LPW Efficiency;
- > IP20 / IK10 Protection;
- > Low glare,especially suit for indoor sport hall lighting solution;
- > Surface powder coating treatment,oxidation/corrosion/ acid Resistant;
- > Ball impact test DIN18032-3 (DIN VDE 0710-13) approval;
- > Multiple Installations: Suspension,Surface mounted;
- > Various Intelligent control: 1-10V, DALI for Option;
- > No UV or IR and completely mercury free;
- > Standard Color for the AI Frame is RAL9016(Matt White), RAL9003 optional;
- > L80/B10:  $\geq 80.000h$ ;
- > Customized supported for special projects;

CE RoHS LM-79 LM-80 SAA

- > High Brightness SAN'AN SMD2835(0.5W) LEDs light source,CRI>80Ra,Meanwell XLG/ELG Driver, with 120LPW Efficiency;
- > Low glare,especially suit for indoor sport hall lighting solution;
- > IP20 / IK10 Protection;
- > 120°beam angle;
- > Surface powder coating treatment,oxidation/corrosion/ acid Resistant ;
- > Ball impact test DIN18032-3 (DIN VDE 0710-13) approval;
- > Multiple Installations: Suspension,Surface mounted;
- > Various intelligent control: 1-10V, DALI for Option;
- > No UV or IR and completely mercury free;
- > L80/B10:  $\geq 80.000h$ ;

#### Options:

- > Driver: Meanwell XLG/ELG;
- > Controls and Dimming: 1-10V / DALI Dimming;
- > Plug: European / Australia plug with 0.75mm<sup>2</sup>/1.5mm<sup>2</sup>/2.5mm<sup>2</sup> 3-pins or 5-pins (dimming) cable;
- > Installation : Suspension, Wall Mounting;
- > Housing Color: RAL9016(Matt White) for Standard, RAL9003 optional;

## Application

- > Replacement for fluorescent NCF;
- > School;
- > Sport Club ;
- > Sport Hall ;
- > Community ;

## Technical Parameters

<b>Model No.</b>	DR-ISPL32152-100HD32X	DR-ISPL32152-150HD32X	DR-ISPL32152-200HD32X
<b>System Watts/W</b>	100W	150W	200W
<b>System Efficiency/LPW</b>	120LPW		
<b>Lumen Output/lm</b>	12.000±5%	15.000±5%	18.000±5%
<b>Rated Input Voltage/V</b>	AC100~277V 50/60Hz		
<b>LEDs Light Source</b>	SMD2835		
<b>SDCM</b>	<6 (≤3 Optional)		
<b>CCT/K</b>	5000K for Standard (3000K/4000K/5700K/6500K Optional)		
<b>CRI/Ra</b>	>80Ra		
<b>Power Factor</b>	>0.92		
<b>THD</b>	<10%		
<b>Beam Angle(Optional)</b>	120°		
<b>UGR</b>	<19		
<b>Surge Protection</b>	4~6KV SPD built in Driver		
<b>LED Driver</b>	Meanwell XLG/ELG Optional with 1-10V dimming,output adjustable driver		
<b>IP Rating</b>	IP20		
<b>Dimming(Optional)</b>	1-10V, DALI		
<b>Safety Protection</b>	Open Circuit / Short Circuit / Over-voltage / Over Temperature Protection		
<b>Start Time</b>	0.5s		
<b>Protection Class</b>	Class I		
<b>Finishing Color(Optional)</b>	RAL9016 Matt White for standard,RAL9003 Optional		
<b>Material</b>	Al+PC		
<b>Lifespan/hrs</b>	80.000 Hrs (Ta=30°C@L80/B10)		
<b>Operation Temp/°C</b>	-40°C to + 50°C(-40°F to 122°F)		
<b>Storage Temp/°C</b>	-40°C to + 65°C(-40°F to 149°F)		
<b>Installation</b>	Suspension / Ceiling Mounting Optional		
<b>Certificate</b>	CE(EMC+LVD),RoHS,ENEC ,SAA,RCM Available		

## Dimensions

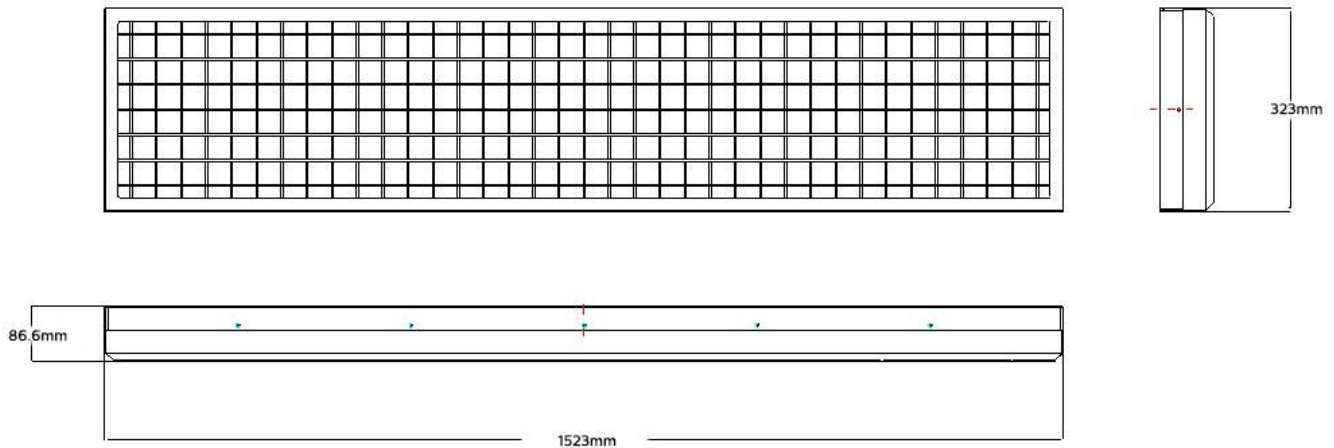

# Photometry Diagram

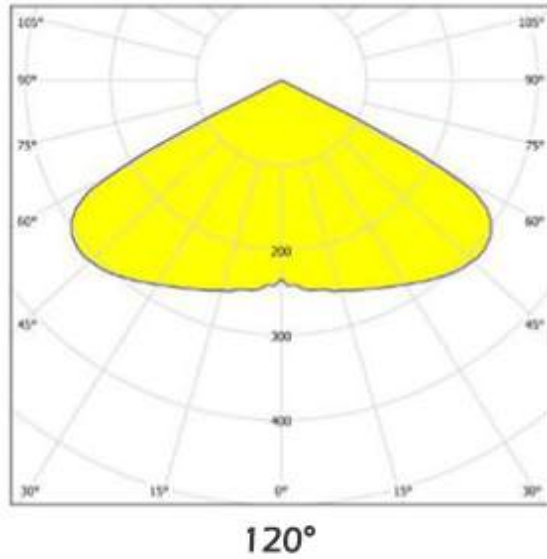

## Installation

### Ceiling Mounted

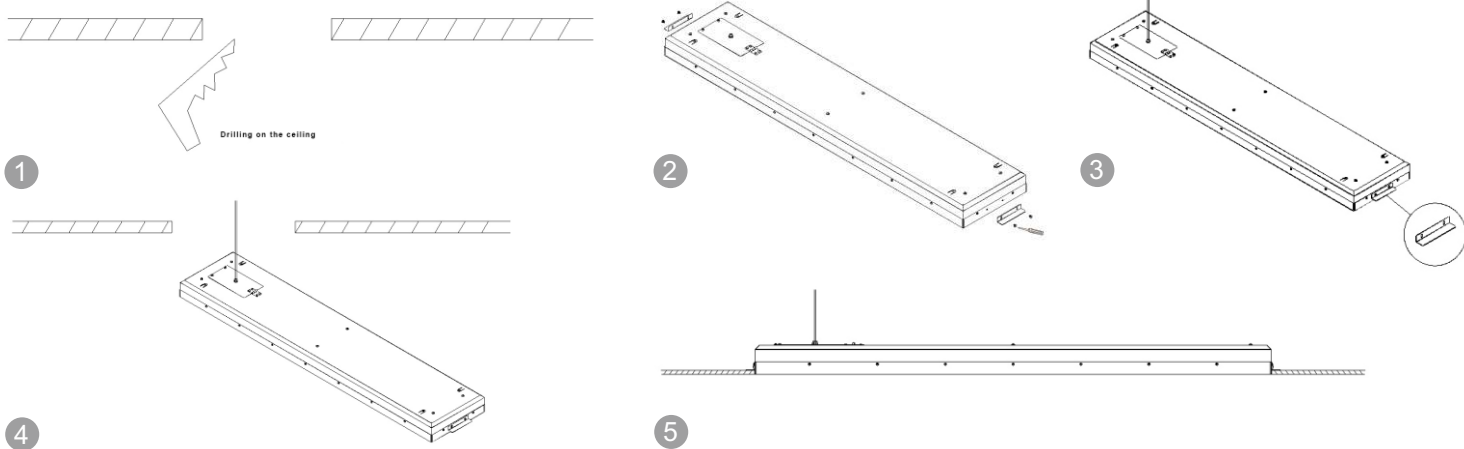

### Suspension

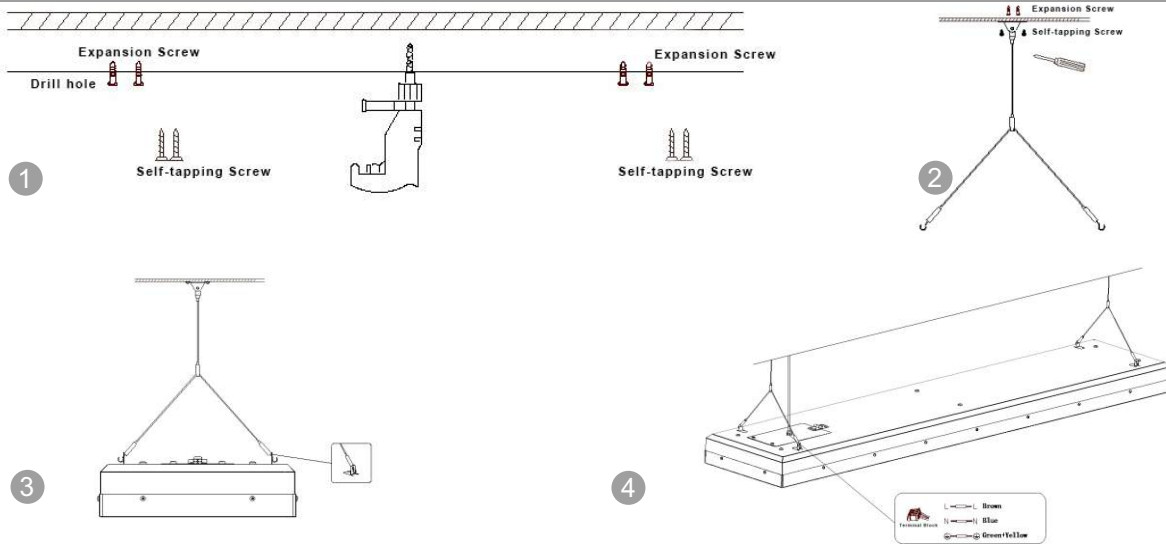

### INSTALLATION GUIDE

#### IMPORTANT SAFETY INFORMATION:

**Please read all the instructions below before installation**

- > Make sure that the supply voltage corresponds to the rated product voltage;
- > The product must be installed by a qualified electrician in accordance with the National Electrical Code and corresponding local codes.
- > If the product is damaged, do not use it!



**Turn Off Power Supply**



# Wiring Diagram



**RISK OF PERSONAL INJURY – READ and follow all WARNINGS and installation instructions.**

Keep or give to the owner for future reference.

**Risk of cuts:** Wear gloves to prevent cuts or abrasions when removing from carton, handling, installing, and maintaining this product.

**Risk of electric shock:** This product must be installed in accordance with the applicable installation code by a person familiar with the construction and operation of the product and the hazards involved.

**Risk of Fire:** Minimum 194°F supply conductors. Consult a qualified electrician to ensure correct branch circuit conductor.

DUALWAYS® assumes no responsibility for claims arising out of improper or careless Installation or handling of this product.

## Packaging Information

Model No.	Net Weight/Kg	Outer Carton Size/mm	Gross Weight/Kg	QTY"/CTN
DR-ISPL32152-100HD32X	12.8	1580*380*140	13.8	1PCS
DR-ISPL32152-150HD32X	13.5	1580*380*140	14.6	1PCS
DR-ISPL32152-200HD32X	14.6	1580*380*140	15.9	1PCS

## Details Demo

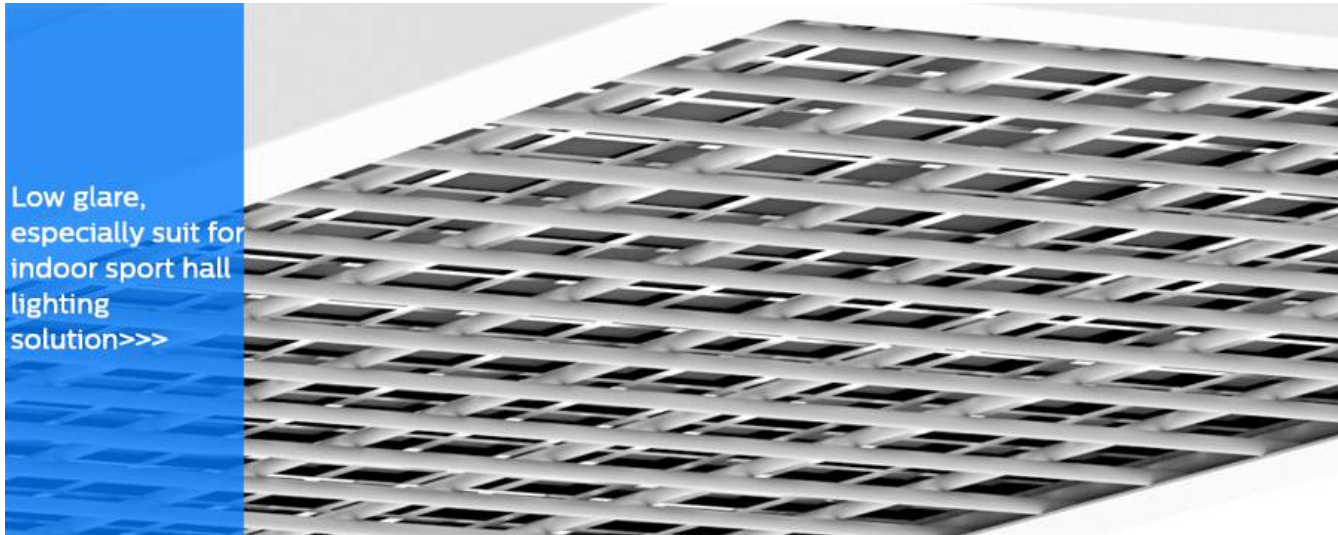

Ball impact test  
DIN18032-3  
(DIN VDE 0710-13  
approval>>>



## Application Reference

